

The Improvement contains about sixty acres with a house Barn & some fruit trees the settlement was commenced in June, 1793 and is continued

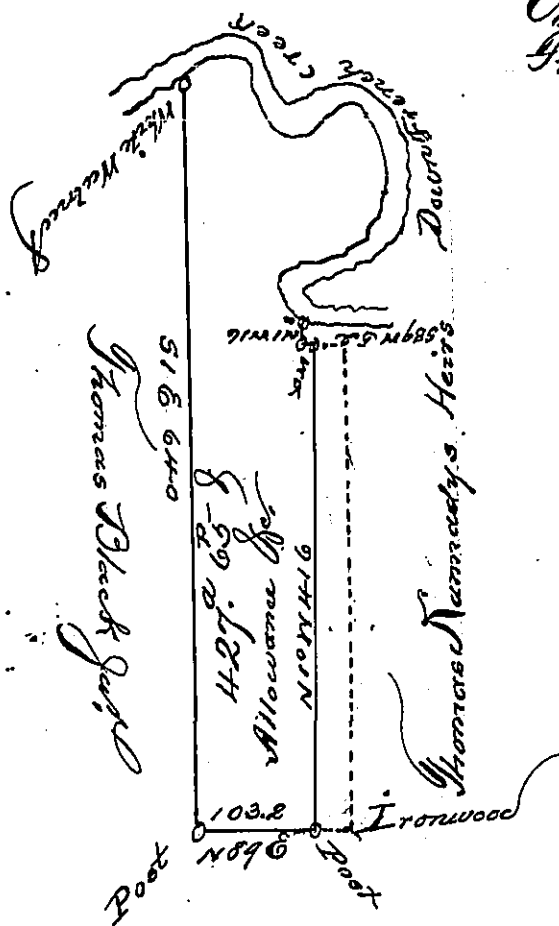

Courses & Distances about French Creek.

N. 73	W	10
N. 41.	W	12
N. 10.	W	18
N. 21.	E	16
N. 74.	E	8
S. 76 1/2	E	18
S. 87	E	16
N. 73	E	20
N. 33	E	28
N. 16	E	20
N. 3	E	54
N. 27	W	34
N. 58	W	34
S. 52	W	20
S. 19	W	12
S. 68	W	32
N. 49	W	21
N. 1	E	42
N. 47	W	12
N. 77	W	40
S. 34	W	30

John Robison

A Draught of a tract of Land Containing four hundred twenty seven acres sixty five perches and a fraction. Situate on the East side of French Creek in Le Boeuff Township Erie County surveyed 20<sup>th</sup> July 1814 to William Black In Virtue of his warrant dated 11<sup>th</sup> January 1811, resurveyed November the 22<sup>nd</sup> November 1820 in pursuance of a decree of the Court of Common Pleas of Erie County of the 2<sup>nd</sup> of February 1819, fixing and establishing the division line between the claims of William Black and Thomas Black Junr

To Jacob Spangler Esq<sup>r</sup>  
Surveyor General

Jonah Cowgill D. J.

IN TESTIMONY that the above is a copy of the original remaining on file in the Department of Internal Affairs of Pennsylvania, made conformably to an Act of Assembly approved the 16th day of February, 1833, I have hereunto set my Hand and caused the Seal of said Department to be affixed at Harrisburg, this second day of June 1903,

Loae P. Brown  
Secretary of Internal Affairs.